



**MODEL** HONDA CBR 125 R

**YEAR** 2011 - 2016

**LINE** FULL SYSTEM

**MUFFLER** SUONO

**SCHEMATIC**

**ELENCO PARTI / PARTS LIST**

#	QTÀ / QTY	DESCRIZIONE / DESCRIPTION	CODICE / CODE
1	1	Vite M5x12 / Screw M5 x 12	50.73.628.1
2	1	DB killer / DB killer	50.DK.072.0
3	1	Tappo in gomma / Rubber stopper	50.73.266.1
4	1	Silenziatore / Muffler	SUONO 320
5	2	Tassello grande / Rubber big block	50.73.203.1
6	1	Staffa in carbonio / Carbon fiber bracket	50.SS.180.1
7	1	Db Killer forato / Drilled DB killer	50.DK.082.0
8	1	Rondella in gomma / Rubber washer	50.73.227.1
9	5	Dado M8 flangiato / Flanged nut M8	50.73.393.1
10	1	Staffa / Bracket	50.SS.973.0
11	2	Rondella in alluminio nera / Black aluminium washer	50.73.221.1
12	1	Vite M8x30 / Screw M8x30	50.73.219.1
13	1	Vite M8x40 / Screw M8x40	50.73.075.1
14	1	Rondella in alluminio / Aluminium washer	50.73.248.1
15	1	Vite M8x60 / Screw M8x60	50.73.078.1
16	1	Tube di raccordo / Link pipe	9773H043S2A
17	1	Tube di raccordo / Link pipe	9773H060S2B
18	2	Tube in gomma per molla / Rubber pipe for spring	50.73.210.1
19	1	Molla lunga / Long spring	50.71.080.1
20	1	Molla media / Middle spring	50.73.359.1

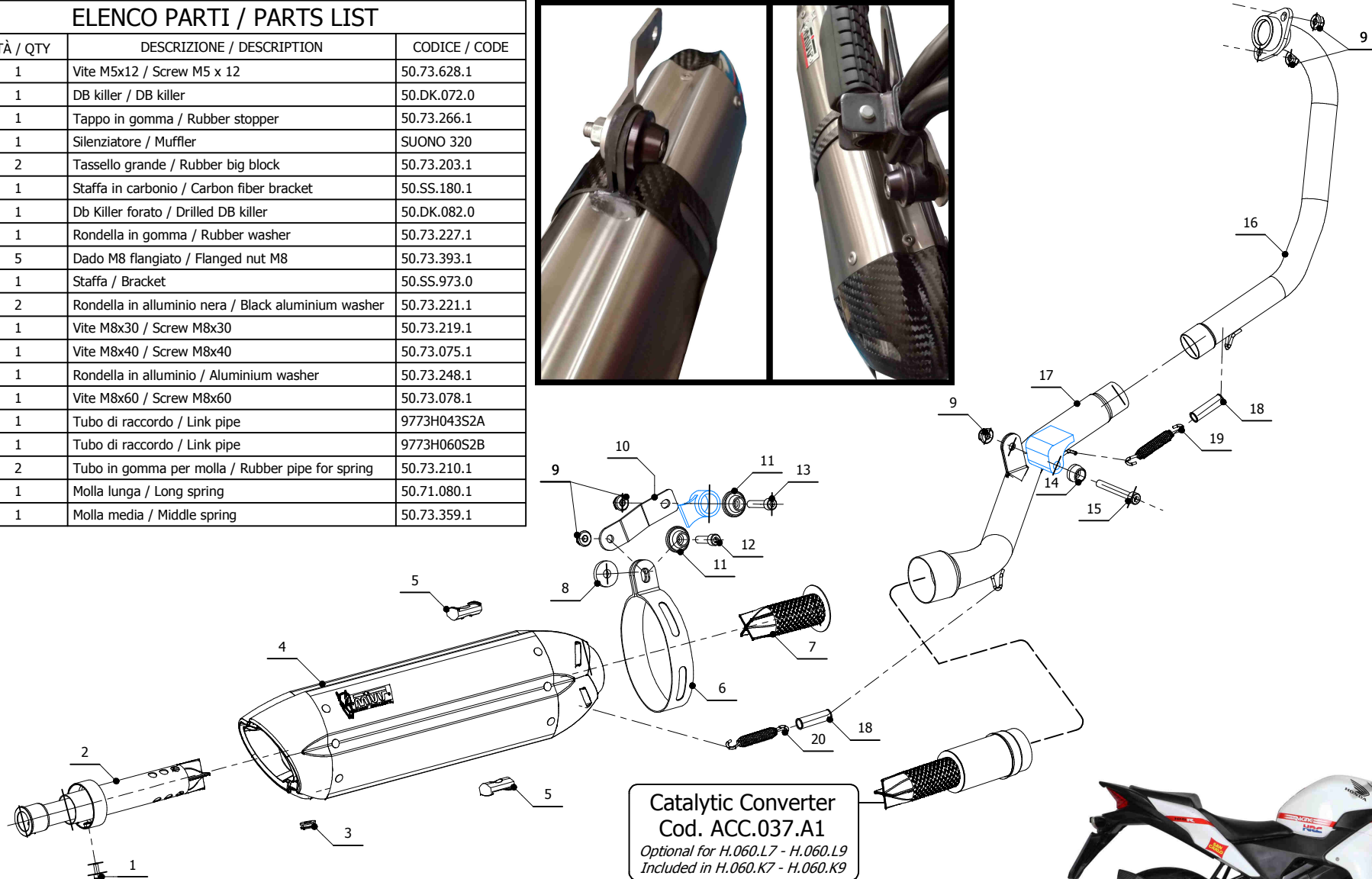

**Catalytic Converter**  
Cod. ACC.037.A1

Optional for H.060.L7 - H.060.L9  
Included in H.060.K7 - H.060.K9

**APPLICAZIONI / APPLICATIONS**

CODICE / CODE	SILENZIATORE / MUFFLER	TUBO / PIPE	FASCETTA / CLAMP	NOTE
H.060.L7 H.060.L9	INOX (COPPE CARBONIO) / ST. STEEL (CARBON CAPS) STEEL BLACK	INOX / ST. STEEL	CARBONIO / CARBON FIBER	CATALYTIC CONVERTER NOT INCLUDED
H.060.K7 H.060.K9	INOX (COPPE CARBONIO) / ST. STEEL (CARBON CAPS) STEEL BLACK	INOX / ST. STEEL	CARBONIO / CARBON FIBER	CATALYTIC CONVERTER INCLUDED

